







Tolerances Expansion Bolts:

Form	 H8	Circularity
	 H8	Cylindricity
Orientation	 H8	Parallelism
	 H8	Perpendicularity
Location	 H8	Position
	 H8	Concentricity

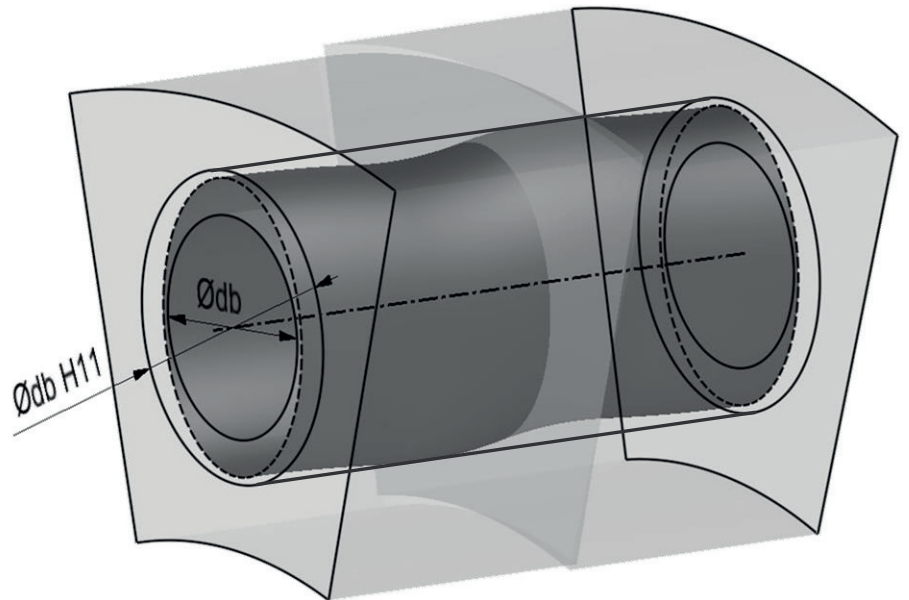

The sum of all tolerances must be smaller than H11; i.e. the bores must lie between two concentric cylinders with diameters $\varnothing db$ and $\varnothing db H11$. If the holes are outside the tolerance, it is advisable to drill them out together to a uniform dimension, which is then within the H8 tolerance over the entire bore length.